

PARAMETROS

PRESION: 1.0 MPa
 TEMPERATURA: -40 - 205 °C
 VELOCIDAD: 16 m/s
 DIMENSIONES: 20-100 mm

MATERIALES

METALES: SS 304, SS 316, SS 316Ti
 CARAS: Rotativa.- carburo de silicio, carburo de tungsteno.
 Asiento.- SS 316, oxido de cromo, carburo.
 SELLOS SECUNDARIOS: Neopreno, vitón, etileno propileno

CARACTERISTICAS

- Sello sencillo
- No balanceado
- Resorte sencillo
- Bi-direccional
- Equivalente a Sealot tipo 1527



TIPO 169
 Sello de empuje resorte único
 (inatascable)

(dependiendo del elastomero)

Marcas registradas: Hastelloy-Haynes / Viton-DuPont / Kalrez-
 DiPont / AFLAS - ASHA / Chemraz - Green Tweed

DIMENSIONES DE INSTALACION

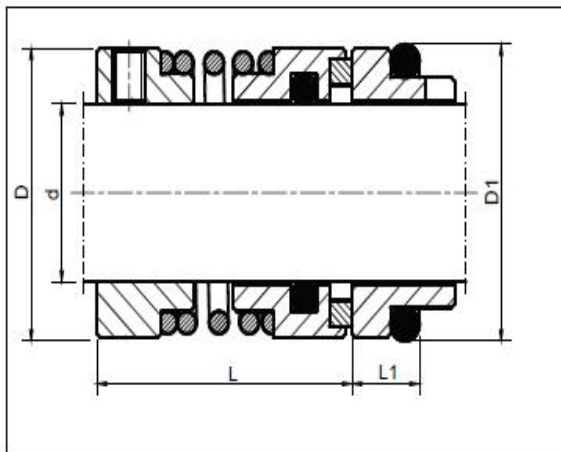

MEDIDAS

| d | D | D1 | L | L1 |
|--------|--------|--------|--------|--------|
| 20 | 34 | 35 | 35.0 | 10.0 |
| 25 | 39 | 40 | 40.0 | 10.0 |
| 28 | 42 | 43 | 40.0 | 10.0 |
| 30 | 44 | 45 | 40.0 | 10.0 |
| 32 | 46 | 48 | 45.0 | 10.0 |
| 35 | 49 | 50 | 45.0 | 10.0 |
| 38 | 54 | 56 | 44.0 | 11.0 |
| 40 | 56 | 58 | 44.0 | 11.0 |
| 45 | 61 | 63 | 49.0 | 11.0 |
| 50 | 66 | 70 | 49.0 | 11.0 |
| 55 | 71 | 75 | 57.0 | 13.0 |
| 60 | 80 | 80 | 57.0 | 13.0 |
| 65 | 85 | 85 | 67.0 | 13.0 |
| 70 | 90 | 92 | 67.0 | 13.0 |
| 75 | 99 | 97 | 64.7 | 15.3 |
| 80 | 104 | 105 | 74.3 | 15.7 |
| 85 | 109 | 110 | 74.3 | 15.7 |
| 90 | 114 | 115 | 74.3 | 15.7 |
| 95 | 119 | 120 | 74.3 | 15.7 |
| 1.625* | 2.250* | 2.375* | 1.500* | 0.500* |

Dimensiones en mm.